

GENERAL NOTES

- DO NOT SCALE THIS DRAWING. WORK ONLY TO FIGURED DIMENSIONS.
- FOR ALL RELEVANT NOTES, REFER TO STRUCTURAL AND CIVIL ENGINEERING PERFORMANCE SPECIFICATION.
- ANY DISCREPANCIES ARE TO BE REPORTED TO PINNACLE CONSULTING ENGINEERS IMMEDIATELY.
- THIS DRAWING IS TO BE READ IN CONJUNCTION WITH ALL OTHER RELEVANT ENGINEERS, ARCHITECTS AND SUB-CONTRACTORS DRAWINGS AND DETAILS.
- THIS DRAWING IS TO BE PRINTED IN COLOUR.
- THIS DRAWING IS NOT TO BE USED FOR CONSTRUCTION PURPOSES UNLESS EXPRESSLY STATED.
- EXISTING SITE AND LEVEL INFORMATION TAKEN FROM LAND SURVEYS TOPOGRAPHICAL SURVEY DRAWING D1728F2D DATED 04/10/06.
- THIS DRAWING HAS BEEN PREPARED USING THE PROPOSED SITE LAYOUT FROM DAVEY + SMITH ARCHITECTS DRAWING IP00 DATED 16/08/24.

LEGEND

- PROPOSED PRIVATE FOUL SEWER
- EXISTING FOUL WATER SEWER
- PROPOSED PRIVATE FOUL SEWER RISING MAIN
- EXISTING BULK WATERMAIN
- EXISTING WATERMAIN
- PROPOSED 150mm HDPE, PE100, SDR17 WATERMAIN
- PROPOSED 100mm HDPE, PE100, SDR17 WATERMAIN
- BOUNDARY BOX AND 25mm OD PE80 SERVICE CONNECTION AS PER IRISH WATER STANDARD STD-W-03
- BOUNDARY BOX AND 32mm OD PE80 SERVICE CONNECTION AS PER IRISH WATER STANDARD STD-W-03
- BOUNDARY BOX AND 65mm OD PE80 SERVICE CONNECTION AS PER IRISH WATER STANDARD STD-W-03
- RETAINING WALL
- PROPOSED SURFACE WATER SEWER
- EXISTING SURFACE WATER SEWER
- SURFACE WATER SEWER TO BE ABANDONED
- 150mm OD uPVC SURFACE WATER PIPE
- SURFACE WATER FIN DRAIN
- SURFACE WATER LAND DRAIN
- DRAINAGE CHANNEL
- ROAD GULLY
- RAINWATER DOWNPIPE
- SW INSPECTION CHAMBER WITH SILT TRAP
- RAIN GARDEN GULLY OVERFLOW
- DETENTION BASIN
- GREEN ROOF
- TRAFFICKED PERMEABLE PAVING
- NON TRAFFICKED PERMEABLE PAVING
- 300mm DEEP RAIN GARDEN
- 900mm DEEP BIO RETENTION TREE PIT
- SUDS DRAINAGE SWALE
- RAIN GARDEN PLANTER BOX

SCALE 1:200
DIMENSIONS IN METRES

REV	DESCRIPTION	BY	CHK/APP	DATE
P01	ISSUED FOR PLANNING	JB	SO'R	02/09/24

CLIENT
CAPAMI LTD

PROJECT
OLDCOURT LRD

DRAWING TITLE
TEMPORARY FOUL PUMPING STATION 1

PINNACLE
CONSULTING ENGINEERS

GROSVENOR COURT,
67A PATRICK STREET,
DUN LAOGHAIRE,
COUNTY DUBLIN,
IRELAND, A96 W3Y7
NORWICH ■ WELWYN GARDEN CITY ■ LONDON ■ THE HAGUE ■ FRANKFURT

DRAWING STATUS				
PLANNING				
SCALE @ A1	DATE	DRAWN BY	CHECKED	APPROVED
1:200	18/06/2024	JB	JB	SO'R
DRG NO.	P211102-PIN-XX-XX-DR-C-00215-S2			REV. P00

COPYRIGHT PINNACLE

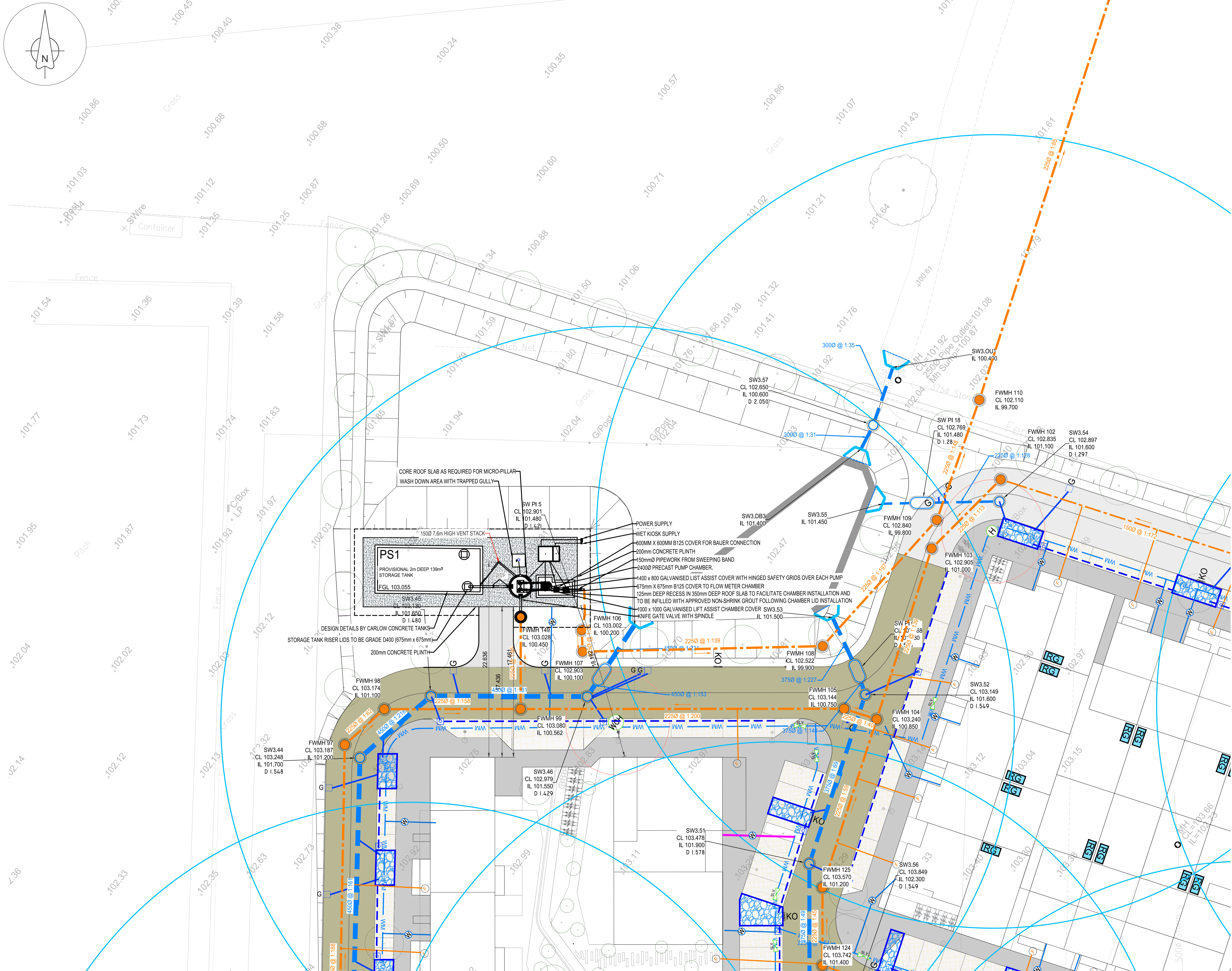

File Location: S:\02\PROJECTS\2021\PROJECT\P211102 - OLDCOURT - LAP LANDS\01 DRAWINGS\62 PINNACLE\02.1 CIVIL\02\06\0215-S2-P00 TEMPORARY FOUL PUMPING STATION.DWG